

Underwater

SLT-UN08



PERFORMANCE DATA

Efficacy : 46.6 Lm/W

Input Voltage : 12-24V DC

Frequency : 50-60 Hz

Color Rendering : CRI 80

Color Temperature : 3000K

Life Time : 50.000 hrs

Optic : 30°

Class : III

MECHANICAL SPECIFICATIONS

Material : Stainless Steel

Mounting : Embedded

Lens : Tempered Glass 6 mm Thickness

Finish : Stainless Steel

Protection Class : IP 68

Mechanical Resistance : IK 09

OPTICS

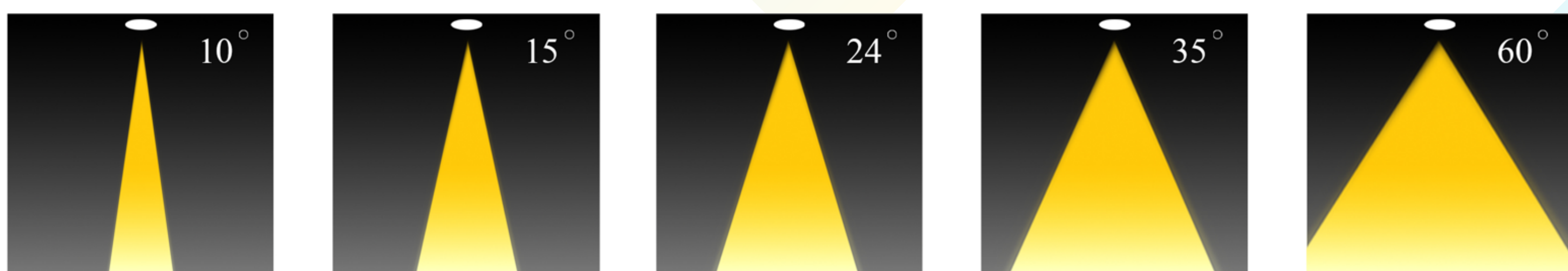

Code	Power W	Efficacy Lm/W	Colour Temp. K	Dimensions ∅ x H mm	Driver	LED Chip	Weight
UN083278030EX003	3	46.6	2700 3000	52x80 mm	Remote Driver (Meanwell)	Epistar	

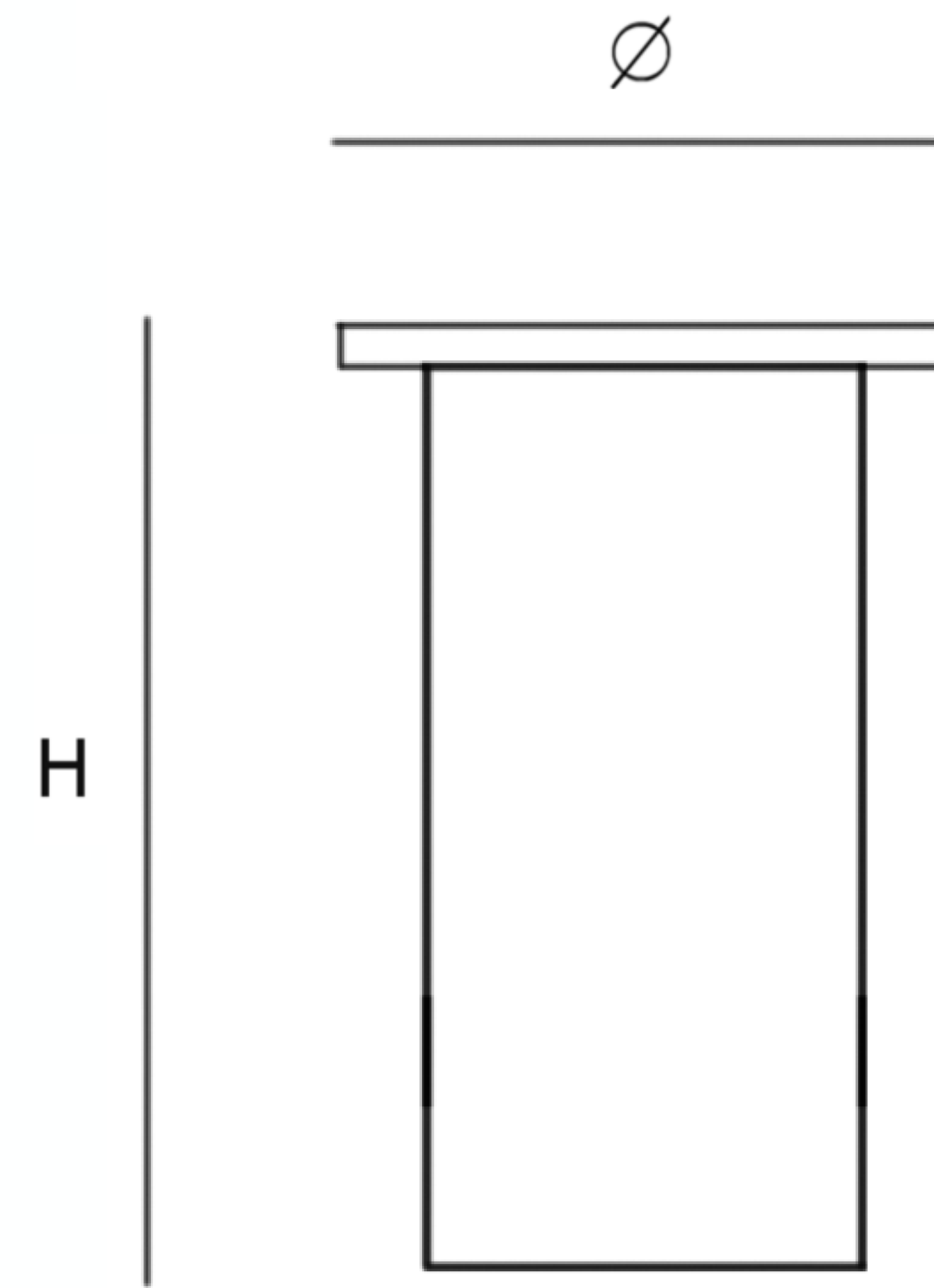

CUSTOMISZE OPTIONS

POLAR CURVE

3K	4K	6.5K	CRI >80	DALI
Light Temperature 3000K	Light Temperature 4000K	Light Temperature 6500K	Color Rendering Index >80	

